



# STANDARD SERIES



**DD PEDESTALS**  
we support!

Smooth height regulation from **30** to **420** mm



# STANDARD series

## Where to use

### Versatile and everlasting

Adjustable pedestal STANDARD Series is a versatile solution for raised outdoor terraces. It allows to adjust the height from 30 up to 420 mm. Smooth height regulation with a rotating screw nut allows to regulate the height even with the tiles on it. For fast height adjustment it can be used with a drill driver bit tool. STANDARD pedestals proved it's quality and usage on thousands of projects in every part of the world. There is a possibility to use with additional accessories.



#### Self leveling head

Automatically slope compensation from 0 to 7%



#### Most popular height range

Height adjustment range from 30 to 420 mm



#### High load resistance

Heavy loads pedestals



#### Screw nut height regulation

Adjust height easily



#### Versatility

Wide range of accessories

### TILE TERRACE



#### Tiles on pedestals

Using a spacer disc creates joint between tiles. Choose between 3 and 5 mm spacers.

### DECKING TERRACE

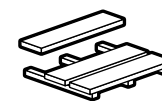

#### Joists on pedestals

Decking joists on the pedestals. Using joist adapter allows to screw them together. It is possible to use joist made of wood, WPC, aluminium.

# STANDARD series

## Pedestal design

### Pedestal construction

STANDARD pedestal has a modular design  
Pedestal height can be extended with a 100 mm height couplers.

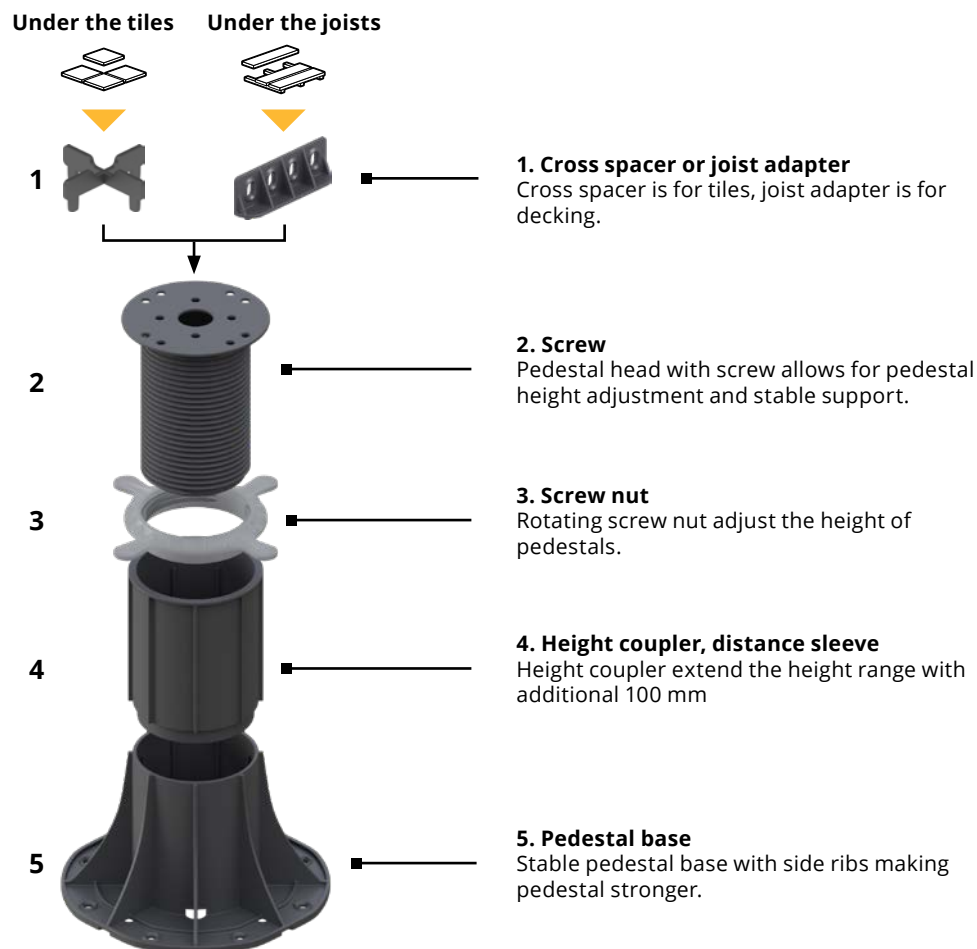

### Smooth height adjustment

STANDARD pedestals allows for smooth height regulation with rotating screw nut.

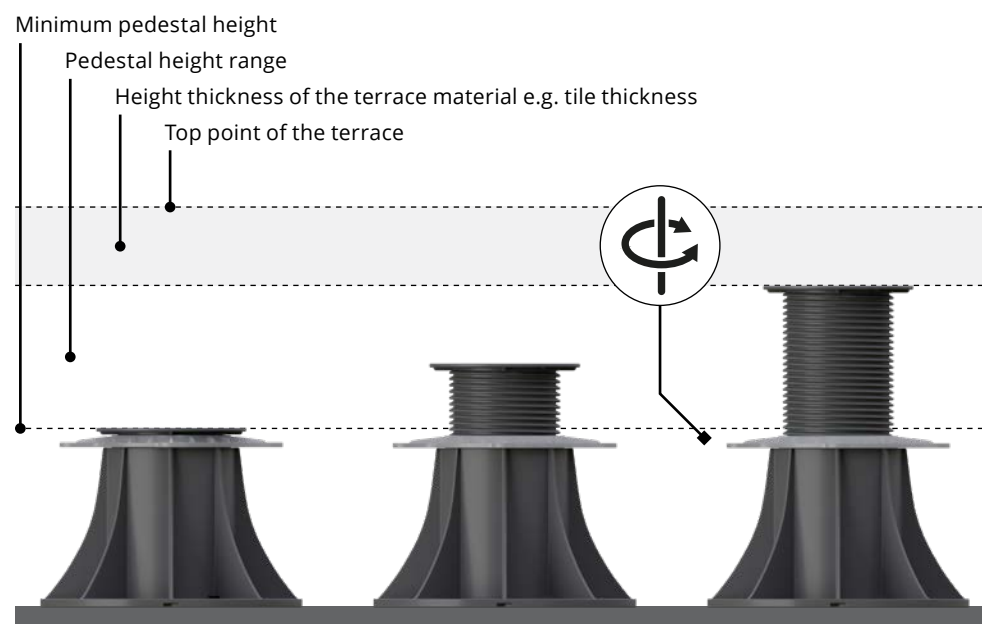

**Deck**

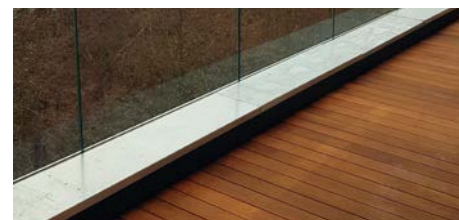

**Terrace tiles**



# STANDARD series

## Advantages

1

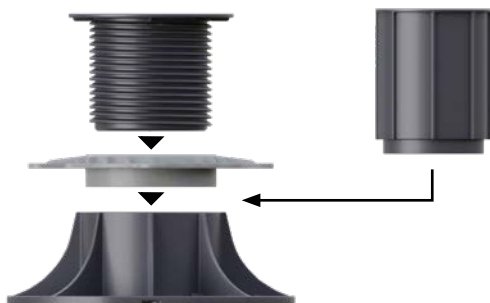

### Easy installation

STANDARD pedestals consists of three parts - base, screw nut and pedestal head with screw. On the pedestal head can be use both cross spacer for tiles and joist adapter for decking.

2

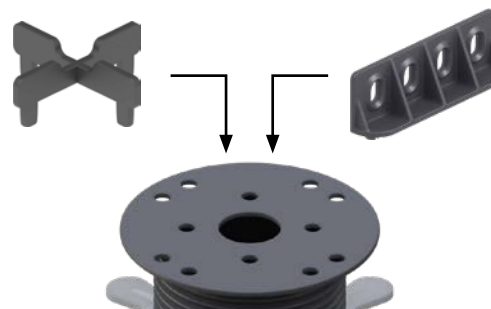

### For tiles and decking

Versatile pedestal head allows for using with cross spacer for tiles and joist adapter for decking.

3

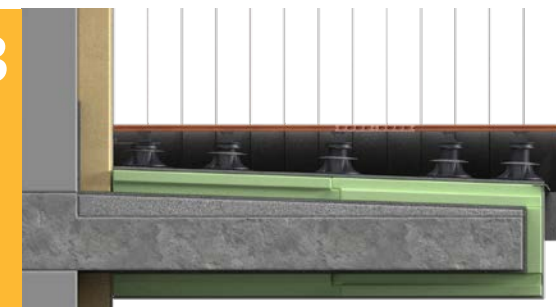

### Terrace basis

STANDARD pedestals can be used on all types of basis even these with a water membrane protection or XPS. Our recommended minimum hardness for stable usage is 300 kPa.

4

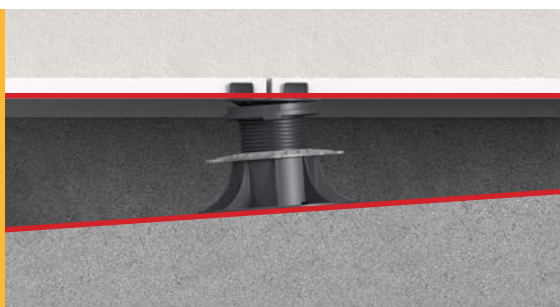

### For a sloped surfaces

STANDARD pedestals can be used on the areas with a radical slope. Using self leveling head allows to compensate slope up to 7%.

5



### Solid support

Wide pedestal head and self leveling head gives a stable support for tiles and for decking.

6



### High load capacity

STANDARD pedestals has a high load capacity.



# STANDARD series

## STANDARD pedestals



### FOR TILES

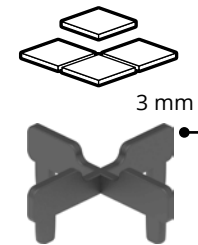

**Cross spacer K3**  
joint width 3 mm

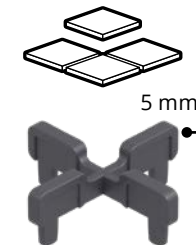

**Cross spacer K5**  
joint width 5 mm

### FOR DECKING JOISTS



**Joist adapter**  
for wood, composite,  
aluminium bars.

STANDARD Series - height range from **30** to **420** mm

500 mm

400 mm

300 mm

200 mm

100 mm



**STANDARD**  
**030-045**  
30 - 45 mm



**STANDARD**  
**45-70**  
45 - 70 mm



**STANDARD**  
**70-120**  
70 - 120 mm



**STANDARD**  
**120-220**  
120 - 220 mm



**STANDARD**  
**220-320**  
220 - 320 mm

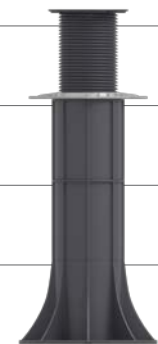

**STANDARD**  
**320-420**  
320 - 420 mm

# STANDARD series

## STANDARD pedestals

### STANDARD pedestal 030-045



| Name                   | STANDARD pedestal 030-045   |
|------------------------|---|
| Application            | <ul style="list-style-type: none"> <li>terrace with tiles</li> <li>terrace with decking</li> </ul>  |
| Short name             | STANDARD 030-045  |
| Code                   | <b>For tiles</b> <ul style="list-style-type: none"> <li>spacer 3 mm: <b>10746</b></li> <li>spacer 5 mm: <b>104201</b></li> </ul> <b>For decking</b> <ul style="list-style-type: none"> <li>joist L adapter: <b>10023</b></li> </ul> |
| Pedestal height range  | <b>30 - 45 mm</b>   |
| Height adjustment      | smooth  |
| Pedestal dimensions    | 177 × 177 × (30 - 45) mm  |
| Pedestal load capacity | 1100 kg   |
| Material               | plastic   |
| Colour                 | black with grey screw nut   |
| Where to use           | <ul style="list-style-type: none"> <li>external decking</li> <li>interior raised floors</li> </ul>  |
| Subsurface             | <ul style="list-style-type: none"> <li>hard subsurface</li> <li>sensitive subsurface</li> <li>sloped surface</li> </ul>   |
| Included               | <ul style="list-style-type: none"> <li>tile cross spacer (3 or 5 mm)</li> <li>or joist L adapter</li> <li>STANDARD pedestal 030-045</li> </ul>  |

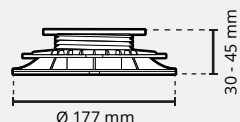

### STANDARD pedestal 045-070



| Name                   | STANDARD pedestal 045-070   |
|------------------------|---|
| Application            | <ul style="list-style-type: none"> <li>terrace with tiles</li> <li>terrace with decking</li> </ul>  |
| Short name             | STANDARD 045-070  |
| Code                   | <b>For tiles</b> <ul style="list-style-type: none"> <li>spacer 3 mm: <b>10747</b></li> <li>spacer 5 mm: <b>104202</b></li> </ul> <b>For decking</b> <ul style="list-style-type: none"> <li>joist L adapter: <b>10027</b></li> </ul> |
| Pedestal height range  | <b>45 - 70 mm</b>   |
| Height adjustment      | smooth  |
| Pedestal dimensions    | 177 × 177 × (45 - 70) mm  |
| Pedestal load capacity | 1100 kg   |
| Material               | plastic   |
| Colour                 | black with grey screw nut   |
| Where to use           | <ul style="list-style-type: none"> <li>external decking</li> <li>interior raised floors</li> </ul>  |
| Subsurface             | <ul style="list-style-type: none"> <li>hard subsurface</li> <li>sensitive subsurface</li> <li>sloped surface</li> </ul>   |
| Included               | <ul style="list-style-type: none"> <li>tile cross spacer (3 or 5 mm)</li> <li>or joist L adapter</li> <li>STANDARD pedestal 045-070</li> </ul>  |

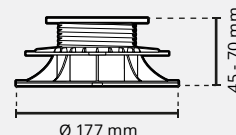

# STANDARD series

## STANDARD pedestals

### STANDARD pedestal 070-120

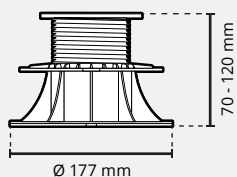

| Name                   | STANDARD pedestal 070-120   |
|------------------------|---|
| Application            | <ul style="list-style-type: none"> <li>terrace with tiles</li> <li>terrace with decking</li> </ul>  |
| Short name             | STANDARD 070-120  |
| Code                   | <b>For tiles</b> <ul style="list-style-type: none"> <li>spacer 3 mm: <b>10748</b></li> <li>spacer 5 mm: <b>104203</b></li> </ul> <b>For decking</b> <ul style="list-style-type: none"> <li>joist L adapter: <b>10031</b></li> </ul> |
| Pedestal height range  | <b>70 - 120 mm</b>  |
| Height adjustment      | smooth  |
| Pedestal dimensions    | 177 × 177 × (70 - 120) mm   |
| Pedestal load capacity | 1100 kg   |
| Material               | plastic   |
| Colour                 | black with grey screw nut   |
| Where to use           | <ul style="list-style-type: none"> <li>external decking</li> <li>interior raised floors</li> </ul>  |
| Subsurface             | <ul style="list-style-type: none"> <li>hard subsurface</li> <li>sensitive subsurface</li> <li>sloped surface</li> </ul>   |
| Included               | <ul style="list-style-type: none"> <li>tile cross spacer (3 or 5 mm)</li> <li>or joist L adapter</li> <li>STANDARD pedestal 070-120</li> </ul>  |

### STANDARD pedestal 120-220

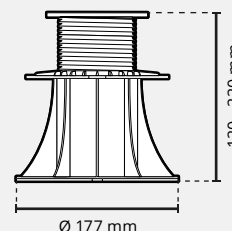

| Name                   | STANDARD pedestal 120-220   |
|------------------------|---|
| Application            | <ul style="list-style-type: none"> <li>terrace with tiles</li> <li>terrace with decking</li> </ul>  |
| Short name             | STANDARD 120-220  |
| Code                   | <b>For tiles</b> <ul style="list-style-type: none"> <li>spacer 3 mm: <b>10749</b></li> <li>spacer 5 mm: <b>104204</b></li> </ul> <b>For decking</b> <ul style="list-style-type: none"> <li>joist L adapter: <b>10035</b></li> </ul> |
| Pedestal height range  | <b>120 - 220 mm</b>   |
| Height adjustment      | smooth  |
| Pedestal dimensions    | 177 × 177 × (120 - 220) mm  |
| Pedestal load capacity | 1100 kg   |
| Material               | plastic   |
| Colour                 | black with grey screw nut   |
| Where to use           | <ul style="list-style-type: none"> <li>external decking</li> <li>interior raised floors</li> </ul>  |
| Subsurface             | <ul style="list-style-type: none"> <li>hard subsurface</li> <li>sensitive subsurface</li> <li>sloped surface</li> </ul>   |
| Included               | <ul style="list-style-type: none"> <li>tile cross spacer (3 or 5 mm)</li> <li>or joist L adapter</li> <li>STANDARD pedestal 120-220</li> </ul>  |

## STANDARD pedestal 220-320



|                               |   |
|-------------------------------|---|
| <b>Name</b>                   | <b>STANDARD pedestal 220-320</b>  |
| <b>Application</b>            | <ul style="list-style-type: none"> <li>terrace with tiles</li> <li>terrace with decking</li> </ul>  |
| <b>Short name</b>             | <b>STANDARD 220-320</b>   |
| <b>Code</b>                   | <b>For tiles</b> <ul style="list-style-type: none"> <li>spacer 3 mm: <b>10749 + 10038</b></li> <li>spacer 5 mm: <b>104204 + 10038</b></li> </ul> <b>For decking</b> <ul style="list-style-type: none"> <li>joist L adapter: <b>10035 + 10038</b></li> </ul> |
| <b>Pedestal height range</b>  | <b>220 - 320 mm</b>   |
| <b>Height adjustment</b>      | smooth  |
| <b>Pedestal dimensions</b>    | 177 × 177 × (220 - 320) mm  |
| <b>Pedestal load capacity</b> | 1100 kg   |
| <b>Material</b>               | plastic   |
| <b>Colour</b>                 | black with grey screw nut   |
| <b>Where to use</b>           | <ul style="list-style-type: none"> <li>external decking</li> <li>interior raised floors</li> </ul>  |
| <b>Subsurface</b>             | <ul style="list-style-type: none"> <li>hard subsurface</li> <li>sensitive subsurface</li> <li>sloped surface</li> </ul>   |
| <b>Included</b>               | <ul style="list-style-type: none"> <li>tile cross spacer (3 or 5 mm) or joist L adapter</li> <li>STANDARD pedestal 120-220</li> <li>height coupler DS100</li> </ul>   |

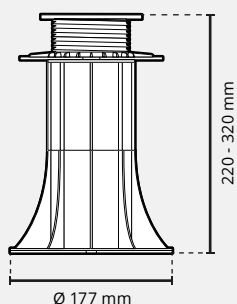

## STANDARD pedestal 320-420



|                               |  |
|-------------------------------|--|
| <b>Name</b>                   | <b>STANDARD pedestal 320-420</b>   |
| <b>Application</b>            | <ul style="list-style-type: none"> <li>terrace with tiles</li> <li>terrace with decking</li> </ul>   |
| <b>Short name</b>             | <b>STANDARD 320-420</b>  |
| <b>Code</b>                   | <b>For tiles</b> <ul style="list-style-type: none"> <li>spacer 3 mm: <b>10749 + 2× 10038</b></li> <li>spacer 5 mm: <b>104204 + 2× 10038</b></li> </ul> <b>For decking</b> <ul style="list-style-type: none"> <li>joist L adapter: <b>10035 + 2× 10038</b></li> </ul> |
| <b>Pedestal height range</b>  | <b>320 - 420 mm</b>  |
| <b>Height adjustment</b>      | smooth   |
| <b>Pedestal dimensions</b>    | 177 × 177 × (320 - 420) mm   |
| <b>Pedestal load capacity</b> | 1100 kg  |
| <b>Material</b>               | plastic  |
| <b>Colour</b>                 | black with grey screw nut  |
| <b>Where to use</b>           | <ul style="list-style-type: none"> <li>external decking</li> <li>interior raised floors</li> </ul>   |
| <b>Subsurface</b>             | <ul style="list-style-type: none"> <li>hard subsurface</li> <li>sensitive subsurface</li> <li>sloped surface</li> </ul>  |
| <b>Included</b>               | <ul style="list-style-type: none"> <li>tile cross spacer (3 or 5 mm) or joist L adapter</li> <li>STANDARD pedestal 120-220</li> <li>height coupler DS100 (2 pcs.)</li> </ul>   |

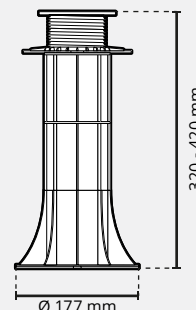



| Image   | Name                     | Where to use   | Short name | Code  | Dimensions<br>a - length<br>b - width<br>h - height | Example of application  |
|---|--------------------------|--|------------|-------|---|---|
|    | <b>Cross spacer 3 mm</b> | Use to create a standard grid gap between tiles with 3 mm width.                                       | K3         | 10800 | a - 60 mm<br>b - 60 mm<br>h - 12 mm                 |    |
|    | <b>Cross spacer 5 mm</b> | Use to create a standard grid gap between tiles with 5 mm width.                                       | K5         | 10801 | a - 60 mm<br>b - 60 mm<br>h - 12 mm                 |    |
|   | <b>Joist adapter</b>     | Helps to fix decking joist to the pedestal.  | AD         | 10000 | a - 85 mm<br>b - 15 mm<br>h - 28 mm                 |   |
|  | <b>Gap spacer 3 mm</b>   | Individual gap spacers are used to helps to create non grid joints between tiles e.g. along the walls. | L3         | 10167 | a - 1 mm<br>b - 3 mm<br>h - 11 mm                   |  |
|  | <b>Gap spacer 5 mm</b>   | Individual gap spacers are used to helps to create non grid joints between tiles e.g. along the walls. | L5         | 10168 | a - 16 mm<br>b - 5 mm<br>h - 15 mm                  |  |

| Image   | Name   | Where to use  | Short name | Code   | Dimensions<br>a - length<br>b - width<br>h - height | Example of application  |
|---|--|---|------------|--------|---|---|
|    | <b>Rubber shim SH100 1,5 mm</b>                | Noise cancellation and tile thickness compensation. Gives additional height of 1,5 mm.  | SH100      | 10399  | a - 100 mm<br>b - 100 mm<br>h - 1,5 mm              |    |
|    | <b>Self leveling head LE 0-7% 16 mm height</b> | Self leveling of the terrace with a slope range from 0% to 7%. Gives additional height of 16 mm.  | LE         | 10170  | a - 110 mm<br>b - 110 mm<br>h - 16 mm               |    |
|    | <b>Up to wall clip</b>                         | Use to create a gap between perimeter tile and wall. Prevent tiles displacement and makes a spare space for tiles thermal expansion. Gives additional height of 2,5 mm. | DDPWAP     | 104368 | a - 189 mm<br>b - 100 mm<br>h - 2,5 mm              |   |
|  | <b>Edge clip upper</b>                         | Use to make vertical closure of the gap under the tiles.  | DDPEDU     | 10040  | a - 152 mm<br>b - 100 mm<br>h - 0,7 mm              |  |
|  | <b>Edge clip lower</b>                         | Use to make vertical closure of the gap under the tiles.  | DDPEDL     | 10039  | a - 50 mm<br>b - 75 mm<br>h - 0,7 mm                |  |

| Image   | Name                                | Where to use  | Short name | Code   | Dimensions<br>a - length<br>b - width<br>h - height | Example of application  |
|---|-------------------------------------|---|------------|--------|---|---|
|    | <b>Side finishing closure plate</b> | It is used to make vertical masking of the ventilated terrace. Two pieces increase the height of the bracket by 7 mm.                                   | DDP CP     | 103741 | a - 257 mm<br>b - 257 mm<br>h - 3,5 mm              |    |
|    | <b>Height coupler 100 mm</b>        | Height coupler allows to extend pedestal height with additional 100 mm.   | DS100      | 10038  | a - 93 mm<br>b - 93 mm<br>h - 100 mm                |    |
|    | <b>SBR rubber pad SBR200, 3 mm</b>  | Placed under the pedestal gives additional protection of the water membrane. Also gives additional noise cancellation. Gives additional height of 3 mm. | SBR 200/3  | 102557 | a - 200 mm<br>b - 200 mm<br>h - 3 mm                |   |
|  | <b>SBR rubber pad SBR200, 8 mm</b>  | Placed under the pedestal gives additional protection of the water membrane. Also gives additional noise cancellation. Gives additional height of 8 mm. | SBR 200/8  | 102559 | a - 200 mm<br>b - 200 mm<br>h - 8 mm                |  |
|  | <b>Drill driver bit tool</b>        | Helps with fast height adjustment of the pedestals. To use drill driver is needed.  | -          | 107471 | a - 62 mm<br>b - 62 mm<br>h - 57 mm                 |  |